

HSS Hire Shops

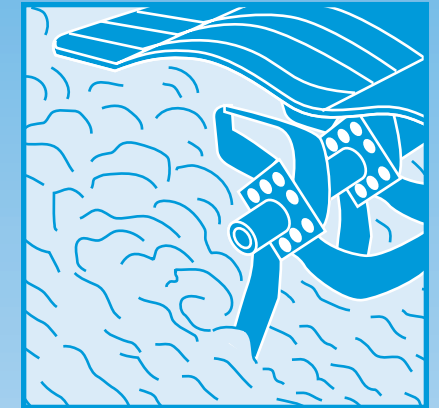

Power Digger

For digging uncultivated ground.



Code 62516

Model 2

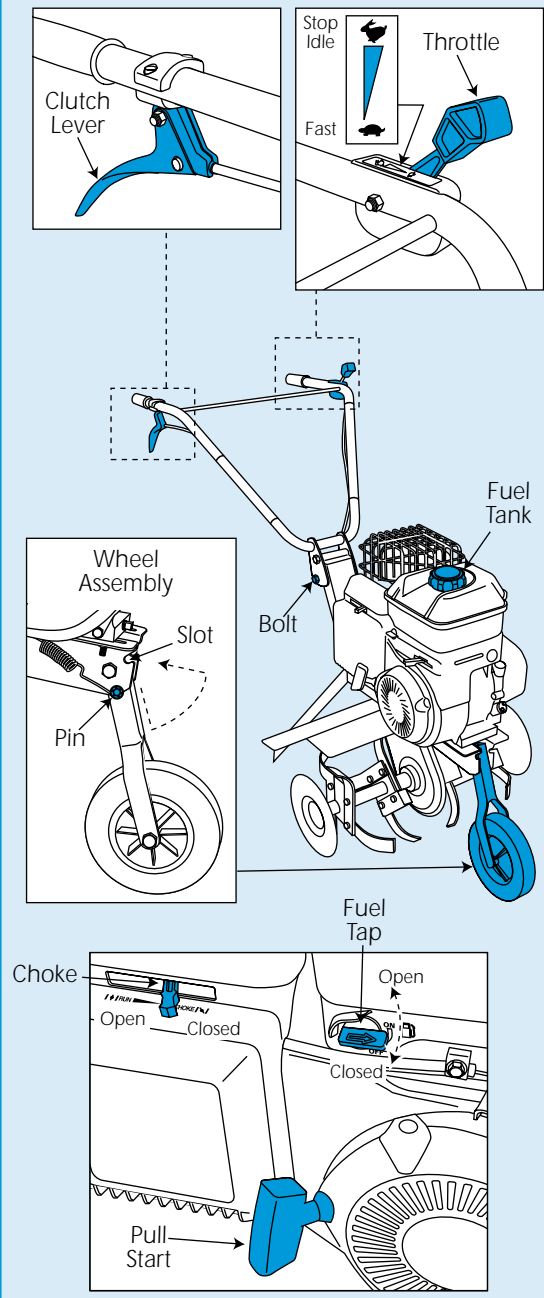

Model 1...
At the end of the strip release the clutch and set the gear selector to neutral before turning the machine round ready for the next run.

Repeat the process until the entire area has been dug, then, if required, dig the area again, this time in gear No2 (medium) to give a finer finish.

To stop in an emergency simply release the clutch lever.

Model 2...

At the end of the strip release the clutch before turning the machine round ready for the next run. Repeat the process until the entire area has been dug.

To stop in an emergency simply release the clutch lever.

EQUIPMENT CARE

Never push the equipment beyond its design limits. If it will not do what you want with reasonable ease and speed, assume you have the wrong tool for the job. Contact your local HSS Hire Shop for advice.

Keep the equipment clean – you will find this less of a chore if you clean it regularly, rather than wait until the end of the hire period.

Regularly check the fuel level and top up as necessary with unleaded petrol.

Regularly check the oil level – when the engine is cold and on level ground. Withdraw the dipstick, wipe it clean, then replace it, remove it a second time and verify that the oil level is between the min and max lines, **top up as necessary.** Suitable oils are available on sale or return from your local HSS Hire Shop.

When not in use, **store the equipment somewhere clean, dry and safe** from thieves.

FINISHING OFF

Release the clutch lever, set the throttle to idle, close the fuel tap and either set the ON/OFF switch to the OFF position or move the throttle lever to the STOP position.

Reset the front wheel to the transport position and where applicable set the depth bar as high as it will go.

Hose the digger down to get it as clean as possible (do this now before the soil dries) **ready for return to your local HSS Hire Shop.**



...any comments?

If you have any suggestions to enable us to improve the information within this guide please fax your comments or write to the Product Manager at the address below
Fax: 020 8687 5001

©HSS Hire Service Group Plc 2001 No. 570/02

Group Office: 25 Willow Lane, Mitcham, Surrey CR4 4TS

Web Site: <http://www.hss.co.uk>

GENERAL SAFETY

For advice on the safety and suitability of this equipment contact your local HSS Hire Shop.

There is a serious risk of personal injury if you do not follow all instructions laid down in this guide.

The hirer has a responsibility to ensure that all necessary risk assessments have been completed prior to the use of this equipment.

This equipment should only be used by an operator who has been deemed competent to do so by his/her employer.

This equipment should be used by an able bodied, competent adult who has read and understood these instructions. Anyone with either a temporary or permanent disability, should seek expert advice before using it.

Keep children, animals and bystanders away from the work area. Cordon off a NO GO area using cones and either barriers or tape, available for hire from your local HSS Hire Shop.

 Never use this equipment if you are ill, feeling tired, or under the influence of alcohol or drugs.

 This equipment generates potentially harmful noise levels. To comply with health and safety at work regulations, ear defenders must be worn by everyone in the vicinity.

 Wear practical, protective clothing, gloves and footwear. Avoid loose garments and jewellery that could catch in moving parts, tie back long hair.

 This equipment is heavy (46Kg), never attempt to lift it on your own, always get help.

Take all necessary precautions to protect yourself and others against the possibility of contracting infectious diseases in your work environment.

Ensure the work area is well lit and ventilated, if in doubt, ask about lighting and ventilation equipment at your local HSS Hire Shop.

Do not work near flammable gases or liquids, petrol or paint thinner fumes for example. Keep combustible materials at a safe distance – at least 5m.

Make sure you know how to switch this machine OFF before you switch it ON in case you get into difficulty.

Survey the area to be dug and ensure that there are NO hidden services (electric cables, soil pipes etc) below the work area. If in doubt, use a cable-avoiding tool available from your local HSS Hire Shop.

Be careful if your view is obstructed, avoid using the digger under low branches where you are forced to crouch to pass under.

The diggers tines can cause serious injury. Always keep feet and hands well away from the tines taking special care when starting.

Never leave the unit running and unattended.

Always switch the engine off and wait for moving parts to come to rest before making adjustments to it.

Exhaust Danger

NEVER operate petrol engines indoors or in a confined space.

The exhaust contains gases that can kill.

Fuel Safety

NEVER refuel while the engine is hot or running.

Never smoke or allow naked lights into the area while refuelling.

Never inhale fuel vapour.

ALWAYS mop up any spillage as quickly as possible, and change your clothes if you get fuel on yourself.

ALWAYS store fuel in a purpose-made sealed container, in a cool, safe place well away from the work area.

Engines, especially the exhausts, get very hot so switch OFF and allow to cool before touching them.

Keep flammable materials well away from engine and exhaust.

Make sure that anyone in the immediate work area is warned of what you are doing.

Check the condition of the equipment before use. If it shows signs of damage or excessive wear, return it to your local HSS Hire Shop.

GETTING STARTED

Clear the area to be cultivated of everything that could get in the machines way – sticks, stones, washing lines etc.

Any long grass should be cut and cleared, as this will clog the tines and reduce the depth of the dig.

Alternatively, remove the top surface with a turf cutter, available from your local HSS Hire Shop.

Ensure the soil is in a suitable condition to be dug, heavy soil should be neither too wet or too dry.

Position the digger on the surface to be worked, set the machine on firm level ground and check fuel and oil levels (see EQUIPMENT CARE).

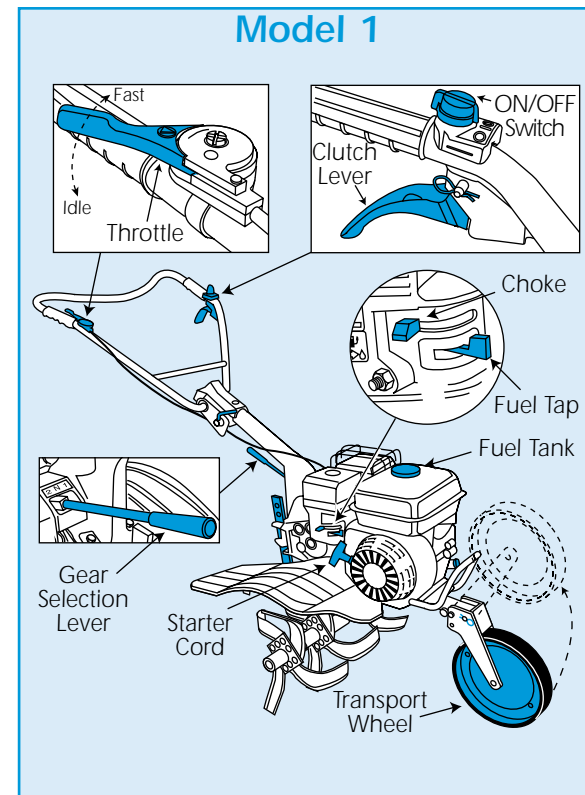

Model 1...

Swing the front transport wheel forwards and secure clear of the ground, release the 'R' clip and remove the pin, swing the wheel assembly up and re-secure using the pin & clip.

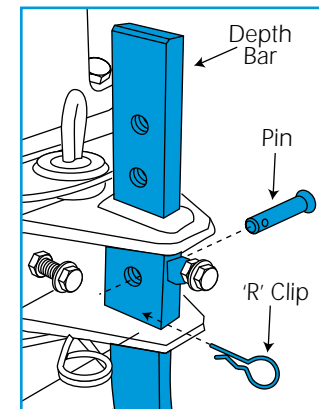

Adjust the rear depth bar to suite the depth you require, this is also held in position with an 'R' clip & pin. The lower the bar the deeper the dig, up to a maximum of about 210mm.

Adjust the handle to a comfortable working height, loosen the lock bar, adjust the handle and re-tighten the lock bar, ensuring it is secure.

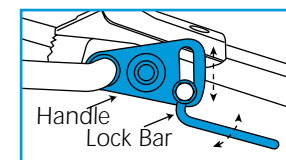

Check that the gear selection lever is in the (N) neutral position.

Turn ON the ON/OFF

switch at the centre of the control handle, open the fuel tap, then set the choke – fully closed if starting from cold, half closed if the engine has warmed up.

With the throttle set to FAST, a few brisk pulls on the starter cord should now start the engine.

Once started, let the engine warm up for a few minutes before opening the choke and resetting the throttle to allow the engine to idle.

Model 2...

Raise the front transport wheel clear of the ground. The wheel assembly is spring-loaded, simply pull the assembly down to disengage the locating pin.

Swing the assembly forwards and up then relocate the pin into the upper slot. To re-deploy the transport wheel, reverse these instructions.

Adjust the handle to a comfortable working height. Undo the lock nut and remove the bolt, reposition the handles and replace the bolt and lock nut.

Open the fuel tap, then set the choke – fully closed if starting from cold, half closed if the engine has warmed up. Set the throttle set to FAST, then a few brisk pulls on the starter cord should now start the engine.

Once started, let the engine warm up for a few minutes before opening the choke and resetting the throttle to allow the engine to idle. Note that to stop the engine, move the throttle lever beyond the idle setting to the STOP position.

BASIC TECHNIQUES

Model 1...

Set the throttle to fast, (the engine should be used at full throttle when digging), select gear No 1 (slow), and slowly squeeze the clutch lever in to activate the tines.

Model 2...

Set the throttle to fast, (the engine should be used at full throttle when digging) and slowly squeeze the clutch lever in to activate the tines.

Whichever model you are using...

When digging a strip of earth, tilt the machine forward while holding it back (it will try to run over the surface) until it begins to cut into the soil, then allow it to progress at its own rate until the strip is complete.

If the digger becomes stuck in one position, tilt it back to allow it to progress.

Stone Alert

Keep a lookout for bricks, large stones, bits of wood, wire etc.

Running into debris could cause serious damage to the digger.