

With the throttle held to the half-way position, a few brisk pulls on the pull start should now start the engine.

Once started, let the engine warm up for a few minutes before opening the choke and releasing the throttle to the idle position.

BASIC TECHNIQUES

Caution

Never bore holes in the vicinity of underground drains, pipes or cables. If in doubt, locate pipes and cables using a suitable metal detector or cable avoiding tool – available from your local HSS Hire Shop.

The throttle is spring loaded, when released the engine will return to idle. If at any time you get into difficulty, release the throttle.

Be prepared for the auger to turn as soon as the engine starts. It should stop once the engine is set to idle.

Take special care if standing on soft or uneven ground.

Position the auger, then increase the engine revs and begin drilling.

Keep the auger vertical, ensuring the engine turns it, not you.

Don't try to force the auger through the soil. Apply just enough pressure to ensure reasonable progress.

Without stopping the auger, withdraw it occasionally to clear the bore.

If the auger stops penetrating, inspect the bore and manually remove any obstructions. Failing that, abandon the bore and try elsewhere.

In very heavy or wet soil, switch OFF periodically and clean the auger.

If the auger becomes stuck in the soil, turn OFF the engine and simply rotate the unit anti-clockwise until it becomes free. For 2 man models, lock the gearbox with the lock lever (see illustration).

EQUIPMENT CARE

Never push the equipment beyond its design limits. If it will not do what you want with reasonable ease and speed, assume you have the wrong tool for the job. Contact your local HSS Hire Shop for advice.

Clean the equipment regularly, rather than wait until

the end of the hire period.

Be sure to use the correct fuel- a mix of 2-stroke oil and unleaded petrol.

Never use 2-stroke oil for lubrication nor mix lubricating oil with petrol as 2-stroke fuel.

When not in use, store the equipment somewhere clean, dry and safe from thieves.

FINISHING OFF

Withdraw the auger from the bore hole, keeping it rotating until it is clear of the soil.

Set the throttle to give minimum revs, then set the ON/OFF switch to OFF and wait for the engine to die then where applicable, turn off the fuel.

That done, twist the knurled collar to open the chuck, remove the auger and, if appropriate, fold up the two man borer's handles.

Give the unit a final clean, ready for return to your local HSS Hire Shop.



...any comments?

If you have any suggestions to enable us to improve the information within this guide please fax your comments or write to the Product Manager at the address below

Fax: 0181-687 5001

©HSS Hire Service Group Plc 1998 No. 575/01

Group Office: 25 Willow Lane, Mitcham, Surrey CR4 4TS

Web Site: <http://www.hss.co.uk>

Operating & Safety Guide 575

HSS Hire Shops

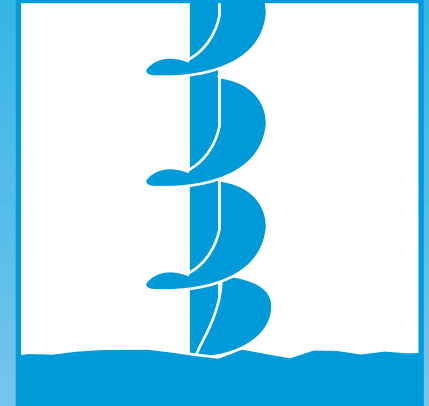

1 & 2 Man Petrol Post Hole Borers

The ONE-MAN POST-HOLE BORER: to take the spadework out of digging post holes.

The TWO-MAN POST-HOLE BORER: a more powerful version for larger, deeper holes.



Code 62725 / 62735



GENERAL SAFETY

For advice on the safety and suitability of this equipment contact your local HSS Hire Shop.

There is a serious risk of personal injury if you do not follow all instructions laid down in this guide.



This equipment should be used by an able bodied, competent adult who has read and understood these instructions. Anyone with either a temporary or permanent disability, should seek expert advice before using it.

Keep children, animals and bystanders away from the work area.

  Never use this equipment if you are ill, feeling tired, or under the influence of alcohol or drugs.

 Safety Goggles MUST be worn by everyone in the work area.

 This equipment generates potentially harmful noise levels. To comply with health and safety at work regulations, ear defenders must be worn by everyone in the vicinity.

   Wear practical, protective clothing, gloves and footwear. Avoid loose garments and jewellery that could catch in moving parts. Ensure the work area is well lit and ventilated.

Exhaust Danger

NEVER operate two stroke petrol engines indoors or in a confined space. The exhaust contains gases that can Kill.

Check the equipment before use, if it shows signs of damage or excessive wear, return it.

Always switch OFF – and wait for moving parts to stop- before attempting to service or adjust the equipment in any way.

Fuel Safety

NEVER refuel while the engine is hot or running. Never smoke or allow naked lights into the area while refuelling.

Never inhale fuel vapour.

ALWAYS mop up spillage's as quickly as possible, and change your clothes if you get fuel on yourself.

ALWAYS store fuel in a purpose-made sealed container, in a cool, safe place well away from the work area.

Engines, especially the exhausts, get very hot, so switch off and allow to cool before touching them.

Keep flammable materials away from the engine and exhaust.

Never leave the engine running and unattended.

Make sure you know how to switch this machine OFF before you switch it ON in case you get into difficulty.

COSHH Information sheets are available from your local HSS Hire Shop.

GETTING STARTED

If using the TWO-MAN BORER...

Open out the handles and secure using the sprung locking pins.

Next, fit the auger into the borer's chuck, opening and closing this by twisting the knurled collar.

Whichever you are using...

Now, lay the borer on its side, leaving the auger free to rotate, and prepare to start the engine.

The engine is fitted with an automatic clutch, when the engine is idling the auger will not rotate. To activate the rotation, open the throttle to the full position.

When starting the engine use half throttle, but be ready in case the auger begins to rotate, if it does simply lower the throttle setting until the auger stops.

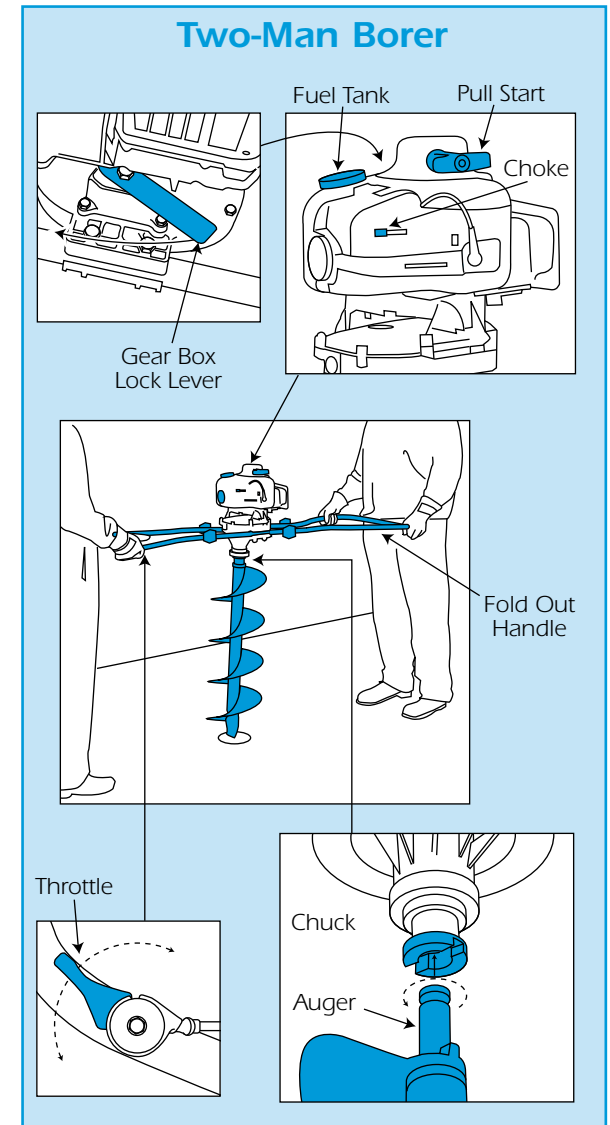
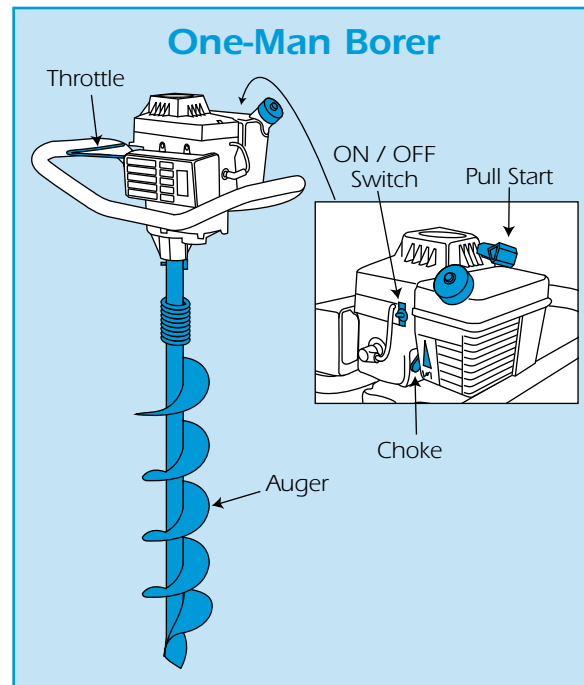

When the unit begins to rotate, it may bounce, so, site the unit in the centre of the work area and keep everyone clear.

Mix 50 parts unleaded petrol with 1 part two stroke oil and fill the fuel tank, a tank full should give about 30 minutes running time. Never add the oil and petrol to the tank unmixed.

Set the ON/OFF switch to the ON position. Open the fuel tap, then set the choke to fully closed if starting from cold, half closed if the engine has warmed up.

Where applicable, push the carburettor tickler button 3 or 4 times to prime the system.