

To start the unit, push the green button, if the unit does not start, reset the red STOP button by turning it clockwise and try again.

To STOP the unit press the red STOP button (reset by turning clockwise).

Replacing the Blade

Having double-checked that it is unplugged and switched OFF, fit the band saw with the appropriate blade for the job.

Undo the 2 clips on the left hand side of the body and swing the front cover fully back, to reveal the 4 guide wheels.

Lower the tension lever (situated between the two top wheels), then slip the blade on to the wheels, ensuring the direction of cut is correct (teeth facing down) and that it passes between both upper and lower guide bearings.

Raise the tension lever and check again that the blade is correctly positioned. Then close and lock the front cover.

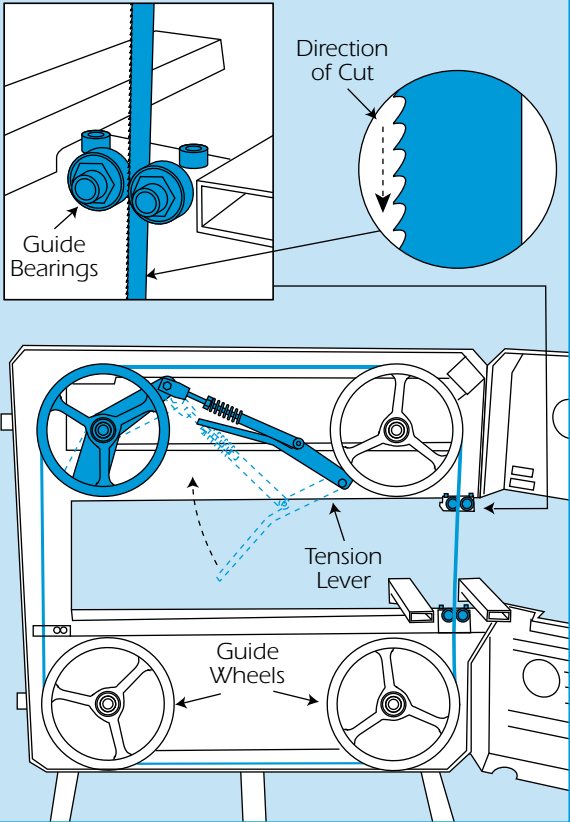

Always **start the saw and let it get up to speed** before bringing the workpiece into contact with the blade.

Adopt a stable stance that gives a good view of the off-cut while keeping you clear of the saw blade. In particular, avoid placing your hands and fingers close to the blade.

Quick Tip

Because band saws cut on the 'down stoke', the workpiece's lower face may be marred by chipping or splintering. Marking cut lines with a knife may reduce damage, but it is still best to saw with the work face up.

Holding the workpiece firmly, guide it into the blade using any pre-marked cutting line, supplying just enough pressure to ensure reasonable progress.

If the workpiece is narrow or small, push it through the blade using a piece of waste timber. **Never allow your hands or fingers to get close to the blade.**

Remove the work from the cut before switching OFF and wait for the blade to stop before clearing any waste off-cut.

EQUIPMENT CARE

Never force the work through the saw. If it jams in the cut, switch OFF, free it and check the blade for damage before going on.

Regularly clean out the tool's ventilation slots. If these clog with dust, the tool's motor could burn out.

Never work with a blunt or dirty blade. It not only produces poor work but could overload the saw's motor.

When cleaning or changing blades, though, do remember to switch OFF and unplug the machine.

When not in use store the equipment somewhere clean, dry and safe from thieves.

Never over-tighten nuts, knobs and screws when making adjustments, **particularly when adjusting guides and guards,** you could damage the unit.

Never use the saw to cut through timber containing nails, screws and other obstacles, unless the blade fitted is designed to do so.

FINISHING OFF

Switch the unit OFF and unplug from the power supply, remove the table and the legs.

Give the unit a final clean then neatly coil the cable ready for return to your local HSS Hire Shop.

Operating & Safety Guide 609

HSS Hire Shops

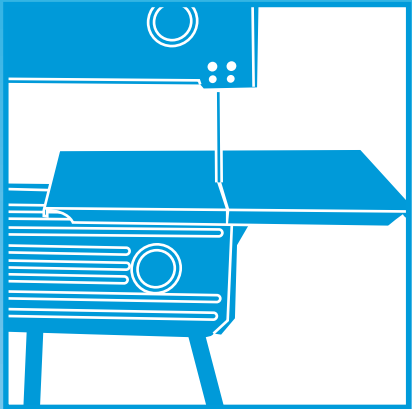

Portable Band Saw

For cutting wood, steel or alloy, with a choice of 100mm or 150mm depth of cut.



©HSS Hire Service Group Plc 1997 No. 609/01
Group Office: 25 Willow Lane, Mitcham, Surrey CR4 4TS

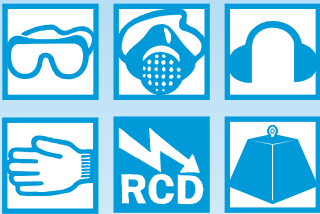

Code 03512

GENERAL SAFETY

For advice on the safety and suitability of this equipment contact your local HSS Hire Shop.

This equipment is designed for operation by an able-bodied adult. Anyone with either temporary or permanent disability must seek expert advice before using it.

Keep children, animals and bystanders away from the work area.

Never use this equipment if you are ill, feeling tired, or under the influence of alcohol or drugs.

This equipment should only be used by a competent person who has read and understood these instructions.

There is a serious risk of personal injury if you do not follow all instructions laid down in this guide.



Safety Goggles MUST be worn by everyone in the work area.



Some materials when cut contain substances which, when inhaled, can be harmful to health. A suitable mask must be worn when using this equipment.



This equipment generates potentially harmful noise levels. To comply with health and safety at work regulations, ear defenders must be worn by everyone in the vicinity.



Wear practical, protective clothing, gloves and footwear. Avoid loose garments and jewellery that could catch in moving parts, tie back long hair.



This equipment is heavy, never attempt to lift a bandsaw by yourself. Always get help.

Make sure you know how to switch this machine OFF before you switch it ON, in case you get into difficulty.

Always unplug the saw before moving it or making adjustments to it.

NEVER start the saw with the blade in contact with the workpiece.

Ensure the work area is well lit and adequately ventilated. Dust extraction and ventilation equipment is available for hire, contact your local HSS Hire Shop for information and advice.

Do not work near flammable gasses or liquids.

Always switch OFF and unplug the equipment when not in use. Never leave it switched ON and unattended.

Never carry or pull the equipment by its flex.

Never remove or otherwise interfere with any safety guards fitted to the saw.

Never use the saw to cut asbestos sheeting, it may yield hazardous dust.

Keep the work area tidy, do not work in areas where you are forced to stand on loose debris or on a slippery uneven surface.

Ensure all guards are correctly adjusted and secure before starting work.

And take care when fitting blades – they are sharp.

Information on COSHH regulations is available from your local HSS Hire Shop.

ELECTRICAL SAFETY

Most HSS Band Saws plug into a standard 13amp power socket. However, 110V models (with a round yellow plug) must be provided with a suitable 110V generated supply, or powered from the mains via a suitable 110V transformer.

If the equipment fails, or if its flex or plug gets damaged, return it. Never try to repair it yourself.

Keep flexes out of harm's way, and clear of the work area.

Extension leads should be fully unwound and loosely coiled, away from the equipment.

Never run leads through water, over sharp edges or where they could trip someone. Don't let them disappear under a pile of off cuts.

Keep the equipment dry, using electrical equipment in very damp or wet conditions can be dangerous.



To reduce the risk of electric shock, use a suitable RCD (Residual Current-Operated Device) available from your local HSS Hire Shop, or power the equipment from a mains circuit with a built-in RCD.

Ensure the band saw and power socket are switched OFF before plugging into the power supply.

GETTING STARTED

Lay the saw on its side and insert the 3 legs into their respective slots, ensuring the split-pins are correctly located.

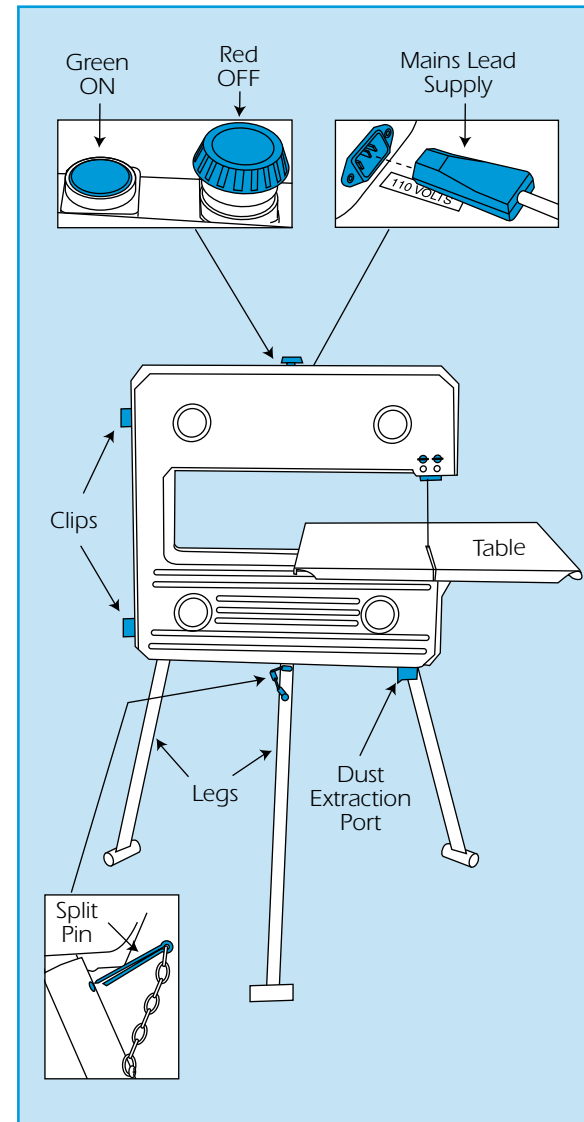
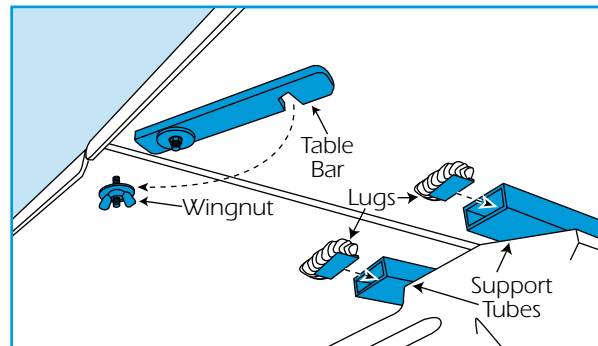

Lift the unit up onto its legs and make sure it is level.

To fit the table, loosen and swing the table bar clear, then slide the table from the back of the unit, making sure you don't twist the blade.

Slide the table forward and over the two lugs so that they are inserted into the table support tubes, then secure in place with the 2 rear catches.

Now re-position the table bar and tighten the wing nut.

All that now remains is to plug the supply lead into the rear of the saw, then plug in and switch ON the power.

Blade Choice

If in doubt, ask at your local HSS Hire shop about the right blade for the job. Blade selection may depend on the material you are cutting, its thickness, whether you are cutting wood along or across the grain.

BASIC TECHNIQUES

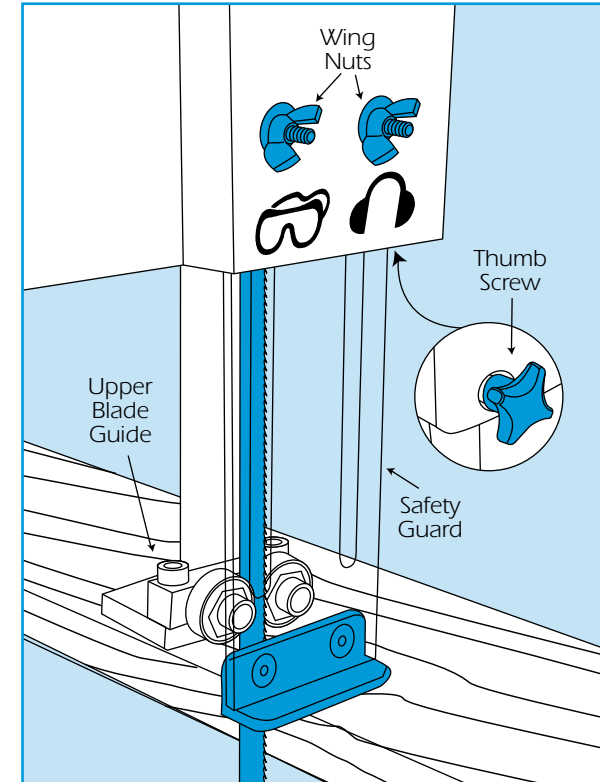

The unit is fitted with an NVR (no volt return) switch, if the power supply is interrupted the unit will switch OFF and will need to be switched back ON once the power is restored.

If this should occur during a cutting operation DO NOT switch back ON until the workpiece has been removed.

Lower the upper blade guide (by loosening the thumb screw at the rear of the head stock) so that it is about 5 mm above the thickest part of the material to be cut then tighten securely in position.

Lower the safety guard by loosening the 2 wing nuts at the front of the head stock, to leave the minimum amount of blade necessary to make the cut.