

BASIC TECHNIQUES

The control pendant has 4 main buttons. The red STOP button isolates the unit from the power supply, in case of an emergency simply press the button once and all electrics are isolated. To re-set the button, turn anti-clockwise until it pops back out.

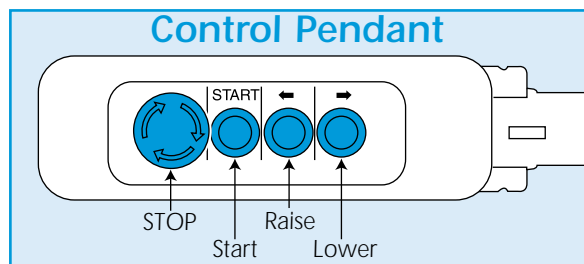

The green start button is depressed in conjunction with the selected direction button.

The 2 remaining buttons have direction arrows, indicating the direction the hoists cable will travel if pressed.

To lower the cable, press and hold the green start button and the button with the down arrow, until the hook is at the required position.

To raise the cable press and hold the green start button and the button with the up arrow until the load is raised to the required position.

Do not use the load cable as a sling.

If the item to be raised has a dedicated lifting eye, ensure it is in a good condition before you attach the hook.

If the item has no lifting eye, suitable slings/chains must be used.

Before lifting ensure the load is free and not restrained by fixing bolts etc.

Determine the loads weight and centre of gravity as accurately as possible.

Attach suitable slings/chains to the load and attach to the cables hook ensuring the hook is not over crowded and that the hooks gate closes correctly.

Use tag lines to control long or bulky loads.

If lifting, lift the load a nominal distance to check balance and security of the load.

Once raised lower as soon as possible, DO NOT leave the load suspended or unattended for any reason.

If the unit or power supply fails during a lift, you can lower the load safely to the ground by inserting the clutch release lever into the opening on the side of the winch housing (see illustration). To lower the load, carefully move the lever forward.

EQUIPMENT CARE

Never push the equipment beyond its design limits. If it will not do what you want with reasonable ease and speed, assume you have the wrong tool for the job. Contact your local HSS Lift & Shift Depot for advice.

Keep the equipment clean, you will find this less of a chore if you clean it regularly, rather than wait until the end of the hire period.

When not in use, **store the equipment somewhere clean, dry and safe** from thieves and unauthorised users.

FINISHING OFF

Lower any raised load and detach from the cables hook.

Detach the winch from its suspension/anchorage point and place all parts together, ready for return to your local HSS Lift & Shift Depot.



...any comments?

If you have any suggestions to enable us to improve the information within this guide please fax your comments or write to the Product Manager at the address below

Fax: 020 8687 5001

©HSS Hire Service Group Plc 2001 No. LS137/01

Group Office: 25 Willow Lane, Mitcham, Surrey CR4 4TS

Web Site: <http://www.hss.co.uk/liftandshift>

HSS Lift & Shift

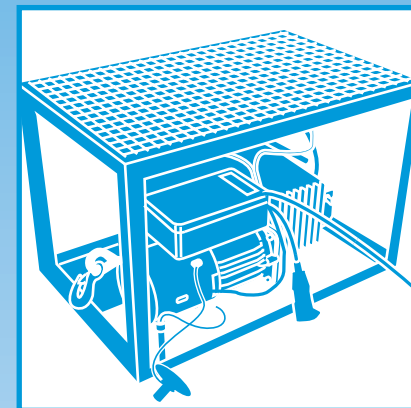

Tirak Mobile Power Winch

An electrically powered cable winch ideal for underground cable pulling and lift shaft maintenance.

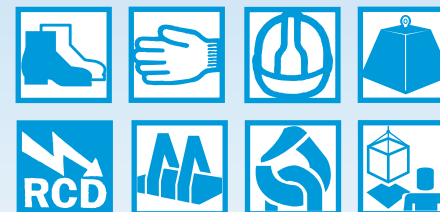

GENERAL SAFETY

For advice on the safety and suitability of this equipment contact your local HSS Lift & Shift Depot.

There is a serious risk of personal injury if you do not follow all instructions laid down in this guide.

The hirer has a responsibility to ensure that all necessary risk assessments have been completed prior to the use of this equipment.

This equipment should only be used by an operator who has been deemed competent to do so by his/her employer.

This equipment is designed to be used by an able bodied, competent adult who has read and understood these instructions. Anyone with either a temporary or permanent disability should seek expert advice before using it.

Keep children, animals and bystanders away from the work area. Cordon off a NO GO area using cones and either barriers or tape, available for hire from your local HSS Lift & Shift Depot.



Never use this equipment if you are ill, feeling tired, or under the influence of alcohol or drugs.



Wear practical, protective clothing, gloves, footwear and a protective hard hat. Avoid loose garments and jewellery that could catch in moving parts, tie back long hair.



Prevent hook overcrowding, with a 'Bow' shackle. Join lifting equipment with a 'D' shackle. Protect sharp edges to prevent load damage.



May be used at any angle for lifting, dragging or pulling. Anchor to a safe, secure point able to take the load force applied. Allow for contact friction if dragging.



Ensure the load is balanced, stable and that personnel stand clear of the raised load.



This equipment is heavy, never attempt to lift it on your own, always get help.

Make sure you know how to operate this equipment safely and are aware of its limitations before you use it.

Make sure that anyone in the immediate work area is warned of what you are doing.

Never leave the equipment loaded or unattended.

Make sure any landing area is unobstructed and able to accept the load in size and weight.

Ensure the work area is well lit and ventilated, if in doubt, ask about lighting and ventilation equipment at your local HSS Lift and Shift Depot.

Do not work near flammable gases or liquids, petrol or paint thinner fumes for example. Keep combustible materials at a safe distance – at least 5m.

Make sure you know how to switch this machine OFF before you switch it ON in case you get into difficulty.

Attach this type of equipment only on structures that are able to bear its weight and its load.

Never exceed the equipment's safe working load of 500Kg.

Safety Warning

This equipment **MUST NOT** be used to carry or lift personnel.

Check the condition of the equipment before use. If it shows signs of damage or excessive wear, return it to your local HSS Lift & Shift Depot.

ELECTRICAL SAFETY

Most HSS Power Winches plug into a standard 240V 13amp earthed power socket. However, 110V models (with a round yellow plug) must be provided with a suitable 110V 16amp generated supply, or powered from the mains via a suitable 110V transformer. If the equipment fails, or if its power supply cable or plug becomes damaged, return it. Never try to repair it yourself.

Only use suitable three core earthed extension leads to power this equipment.

Keep cables out of harms way, and clear of the work area.

Extension leads should be fully unwound and loosely coiled, away from the equipment. Never run them through water, over sharp edges or where they could trip someone.

Keep the equipment dry, using electrical equipment in very damp or wet conditions can be dangerous.



To reduce the risk of electric shock, always use a suitable RCD (Residual Current-Operated Device) available from your local HSS Lift and Shift. Or power the equipment from a mains circuit with a built in RCD.

Ensure the machine and power socket are switched OFF before plugging into the power supply.

GETTING STARTED

Check that the winch you have hired has a sufficient Safe Working Load (SWL) for the item being lifted.

Make sure that the winch you have hired has a long enough cable for the load you are moving. HSS offer this equipment with either a 50 metre or 80 metre cable, contact your local HSS Lift and Shift Depot for advice.

Check and confirm that the suspension/anchor point for the winch is tested and certified to the equivalent (or preferably greater) SWL of the winch.

Tirak Mobile Power Winch

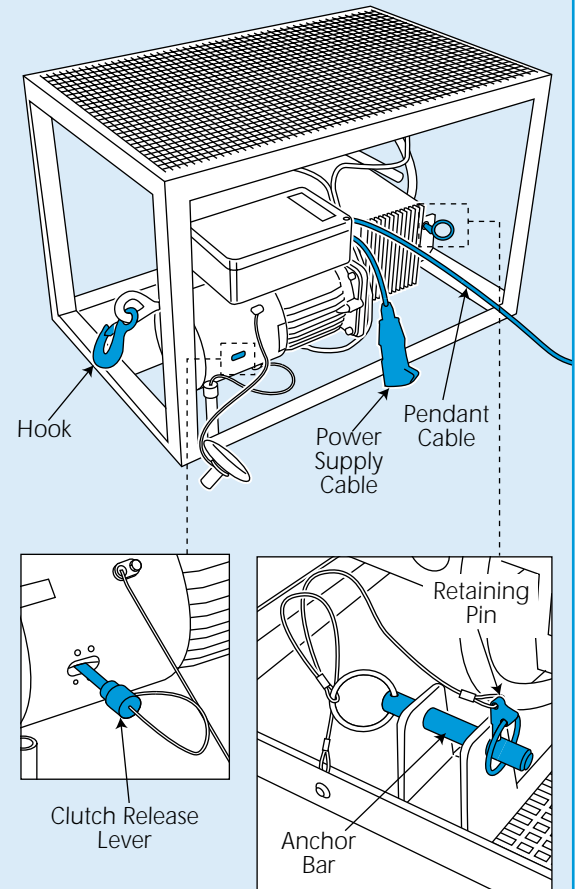

Visually inspect the winch, paying special attention to the condition of the cable and hooks. The cable should be clean and free from dust, dirt, moisture and grease. If the cable is gouged, twisted or has distorted in any way DO NOT USE IT, return it to your local HSS Lift & Shift Depot.

Hooks **MUST** be distortion free and the gate must return under spring load.

Allow a 10% safety margin to accommodate dynamic forces that may arise during the course of a lift.

Attach the winch to a suitable tested suspension/anchorage point, using the anchor bar. Make sure the bars retaining pin is correctly located before proceeding.

All that remains is to plug the unit into its power supply and switch the supply ON.