

**information on the materials natural moisture content.** This is most important when dealing with wood products.

**When using the unit to detect rising damp,** if the light stays with **in the green area, the moisture content is normal** and rising damp should not be suspected. The **yellow area indicates a suspicion of dampness.**

If the light reaches **the red area, there is a damp problem** that will need to be rectified. The higher the reading, the greater the saturation.

## EQUIPMENT CARE

**Never push the equipment beyond its design limits.** If it is unsuitable for the task you are performing **DO NOT USE OR RELY ON IT.** Contact your local HSS Safe and Sure Depot for advice.

**Keep the equipment clean** - you will find this less of a chore if you clean it regularly, rather than wait until the end of the hire period.

When not in use, **store the equipment somewhere clean, dry and safe** from thieves.

## FINISHING OFF

**Replace the electrode protective cover, then disconnect the remote sensor if being used.**

**Place everything in the case ready for return,** to your local HSS Safe and Sure Depot.



## ...any comments?

If you have any suggestions to enable us to improve the information within this guide please fax your comments or write to the Product Manager at the address below  
**Fax: 020 8687 5001**

## Operating & Safety Guide SS611

SS611/01

**HSS** **Safe & Sure**  
SAFETY & SURVEY EQUIPMENT HIRE

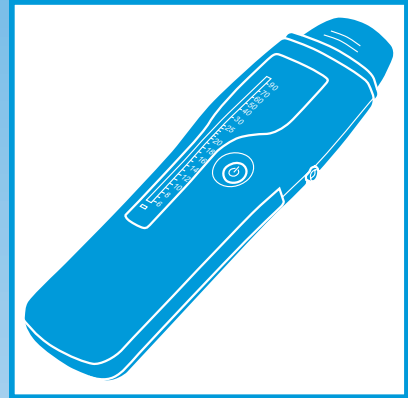

# Damp Meter

**A hand held device for measuring moisture content in various materials.**

©HSS Hire Service Group Plc 2003 No. SS611/01

Group Office: 25 Willow Lane, Mitcham, Surrey CR4 4TS

Web Site: <http://www.hss.com/safeandsure>

Code 49420

## GENERAL SAFETY

**For advice** on the safety and suitability of this equipment **contact your local HSS Safe and Sure Depot.**

**There is a serious risk of personal injury** if you do not **follow all instructions** laid down in this guide.

The hirer has a responsibility to **ensure that all necessary risk assessments have been completed** prior to the use of this equipment.

**This equipment should only be used by an operator who has been deemed competent to do so by his/her employer.**

**This equipment may be used in a workplace subject to a permit to work.**

**It is the hirers responsibility to ensure that the equipment's technical specification meets the requirements of any such permit to work** prior to starting work. For further technical information contact your local HSS Safe and Sure Depot.

**This equipment should be used by an able bodied, competent adult** who has read and understood these instructions. Anyone with either a temporary or permanent disability, should seek expert advice before using it.

**Keep children, animals and bystanders away from the work area.** Cordon off a NO GO area using either cones, barriers or tape, available for hire from your local HSS Safe and Sure Depot.

 **Never use this equipment if you are ill, feeling tired, or under the influence of alcohol or drugs.**

**Wear sensible, suitably protective clothing and footwear** plus any safety wear appropriate to the work in progress.

**Make sure you know how to operate this equipment safely and are aware of its limitations** before you use it. **Make sure that everyone is aware of what you are doing.**

**Check the condition of the equipment before use.** If it shows signs of damage or excessive wear, return it to your local HSS Safe and Sure Depot.

Take all necessary precautions to **protect yourself and others against the possibility of contracting infectious diseases in your work environment.**

**Always switch OFF the equipment when not in use.**

**Ensure the work area is well lit and ventilated,** if in doubt, ask about lighting and ventilation equipment at your local HSS Safe and Sure Depot.

## GETTING STARTED

**Remove the Damp Meter from its case,** complete with the remote cable.

**To switch the unit ON** press the **ON button** and the unit will perform a self test. The unit will switch itself off automatically after 30 seconds of non-activity.

**The ON lamp will illuminate,** to indicate the unit is ready.

## Damp Meter

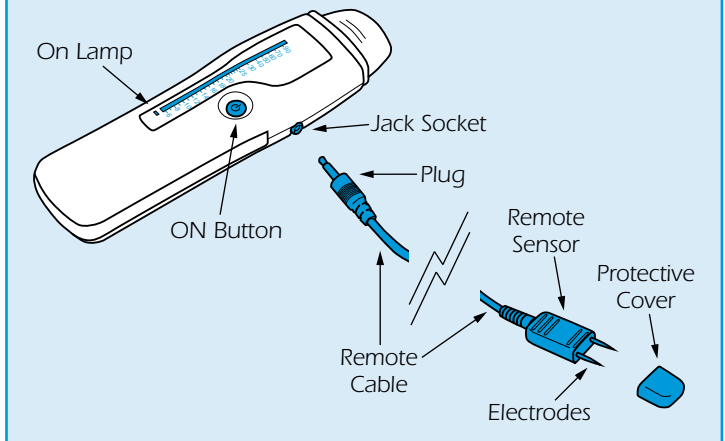

You can now **reveal the twin electrodes** by carefully **removing the protective cover.**

If using the remote sensor, this **should be plugged into the jack socket on the side of the unit** before **switching ON.**

## BASIC TECHNIQUES

### Electrodes

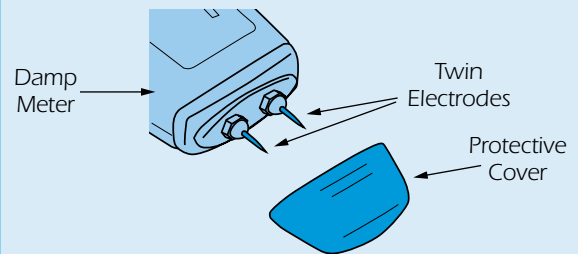

**Switch the unit ON** then once ready, **remove the electrodes protective cover.**

**Push the electrodes against the surface of the material being tested,** allowing the tips to penetrate the surface. Test awkward areas using the remote sensor attachment

**The lights and scales indicate the percentage of moisture within the material being tested,** on a scale of 1 to 100.

**These percentages should be read along side**

### Scale

