

## DIGITAL DISPLAY READINGS

### BLOWER POWER

- P9** The blower easily achieves full airflow  
**P6** In combined filters adequate as new  
**P3 P2** When using particle filters - change filters  
**P0** Change filters immediately

### BATTERY

- A9** Fully charged  
**A0** Change battery - an audible alarm sounds goes off

## CONNECTING THE BLOWER UNIT TO THE HEADPIECE

Make sure the blower unit is fully charged.

Screw one end of the hose onto the side of the headpiece and fit the other end to the blower, simply turn clockwise until hand tight.

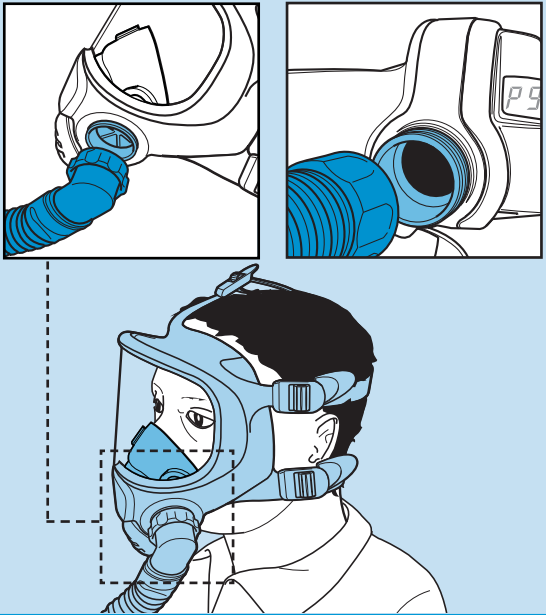

## SPECIFICATIONS

<b>Approvals:</b>	EN 12941 & 12942. CE 0121.
<b>Operation temperature:</b>	-10 °C ... + 50 °C
<b>Air flow:</b>	Minimum 120 l/min, automatic adjustment.
<b>Operating time:</b>	7-15 hours from a single charge, (depending on the filter/facepiece combination.)
<b>Charger:</b>	6 hours' recharging time from flat.
<b>Weight of unit:</b>	1,4 kg

## EQUIPMENT CARE

**Never push the equipment beyond its design limits.** If it will not do what you want with reasonable ease and speed, assume you have the wrong equipment for the job. Contact HSS Hire for advice.

**Handle the equipment with care.** Avoid dropping it, knocking it, or otherwise exposing it to damage.

**Never subject this equipment to prolonged exposure to excessive moisture, or dangerous / corrosive chemicals.**

## CLEANING

**THE OPERATOR HAS A DUTY OF CARE TO ENSURE THE EQUIPMENT IS RETURNED CLEAN OF ANY POTENTIALLY HARMFUL CONTAMINANTS. EQUIPMENT THAT HAS NOT BEEN CLEANED WILL NOT BE ACCEPTED BACK BY HSS.**

**Keep the equipment clean** - you will find this less of a chore if you clean it regularly, rather than wait until the end of the hire period.

**When not in use, store the equipment somewhere clean, dry and secure.**

## FINISHING OFF

**Remove the headpiece, switch the blower unit OFF, then remove the belt.**

**Disconnect the air hose from the headpiece and the blower unit.**

**Clip the inlet cover plugs to the filters.**

**Now clean any contaminants from the equipment.**

**Finally, place everything together, ready for return to HSS Hire.**



## ... have you been trained

The law requires that personnel using this type of equipment in the workplace must be competent and qualified to do so. Training is available at HSS Training 0845 766 7799

## ...any comments?

If you have any suggestions to enable us to improve the information within this guide please e-mail your comments or write to the Safety Guide Manager at the address below e-mail: [safety@hss.com](mailto:safety@hss.com)

©HSS Hire Service Group Ltd 2012 No. SS769/01

Group Office: 25 Willow Lane, Mitcham, Surrey CR4 4TS

Web Site: <http://www.hss.com>

SS769/01

Operating & Safety Guide SS769

**HSS Hire**

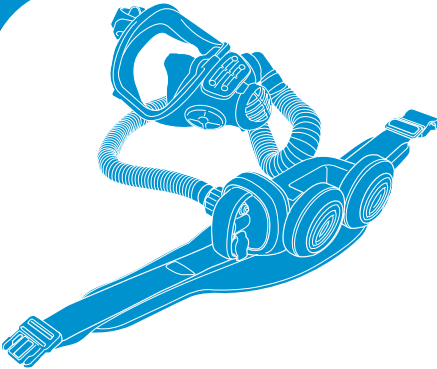

**Full Face  
Powered  
Respirator**

Electronically controlled air supply to maintain comfortable airflow.



Code 34050

## GENERAL SAFETY

**For advice** on the safety and suitability of this equipment contact HSS Hire.

**There is a serious risk of personal injury if you do not follow all instructions laid down in this guide.**

**The hirer has a responsibility to ensure that all necessary risk assessments have been completed prior to the use of this equipment.**

**This equipment should only be used by an operator who has been deemed competent to do so by his/her employer.**

**This equipment may be used in a workplace subject to a permit to work, it is the hirers responsibility to ensure that the equipment's technical specification meets the requirements of any such permit to work prior to starting work. For further technical information contact HSS Hire.**

**Only a competent person who has read and understood these instructions should use this equipment.**

 **Never use this equipment if you are ill, feeling tired, or under the influence of alcohol or drugs.**

 **Wear the protective clothing and footwear required for the application, when using this equipment.**

**Before using the respirator always check for any signs of damage. Do not use a damaged equipment.**

**Do not try to repair or modify the equipment.** If this tool can't do what you expect or fails to work return to HSS Hire.

### WARNING

**THESE UNITS ARE NOT SUITABLE FOR ANY ENVIRONMENT WHICH COULD BE IMMEDIATELY DANGEROUS TO LIFE OR HEALTH.**

**Ensure the work area is tidy, well lit and adequately ventilated.** Lighting and ventilation equipment is available from HSS Hire.

**Make sure you know how to operate this equipment safely and are aware of its limitations** before you use it.

**Do not use in concentrations of contaminants above: 40 x the Occupational Exposure Limit (OEL), above 1000ppm or above the immediately dangerous to life and health level.**

**Do not use in stills, tanks or other confined spaces.**

**Do not use with ASBESTOS.**

**Never use outside the temperature range of -10 degrees C to 40 degrees C.**

**Do not use where humidity levels exceed 95% RH.**

**Do not use in atmospheres enriched or deficient in OXYGEN i.e. enclosed and unventilated areas. The required percentage of oxygen in air is between 19.5%**

**and 21% OXYGEN.**

**Do not use where excessive facial hair can interfere with the face seal and hence reduce protection afforded by this device.**

**Remember that this equipment does not guarantee life protection** but if used correctly it will help provide a safer environment to work in.

**Make sure that anyone in the immediate work area is warned of what you are doing.**

**If the equipment fails, or any part is damaged, return it to HSS Hire. Do not continue to use or attempt to repair it yourself.**

## BATTERY & ELECTRICAL SAFETY

The HSS Full Face Power Respirator has built in battery that plugs into a standard 230V 13amp power socket.

The charger is NOT designed to be used in a zone 1 area. When recharging the battery, place the unit and charger in a safe area.

To charge the battery lift socket flap, plug the charger lead into the battery inlet, then plug the charger into a suitable power supply and switch the power ON. Recharging is fully automatic.

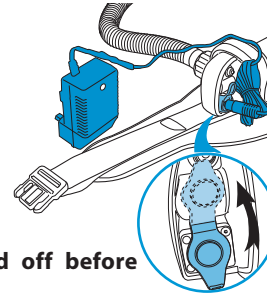

**Ensure the unit is switched off before charging the batteries.**

A single charge allows the user to work for a full shift. The exact battery life depends on the combination of filter and face piece (7-15 hours). It takes 6 hours to charge from flat. The battery technology does not exhibit "memory" effect and there is consequently no need for complete discharge before recharging.

When A9 is shown on the digital display, the battery is fully charged and can supply maximum power. When A0 flashes on the display, battery capacity has dropped below the required level. An audible low battery alarm sounds around 10-15 minutes before the end of service.



When this happens, vacate the work area and recharge the unit.

If the equipment fails, or if its socket becomes damaged, return it. Never try to repair it yourself.

 **To reduce the risk of electric shock, always use a suitable RCD (Residual Current-Operated Device) available from HSS Hire.**

## IDENTIFIER

### BLOWER

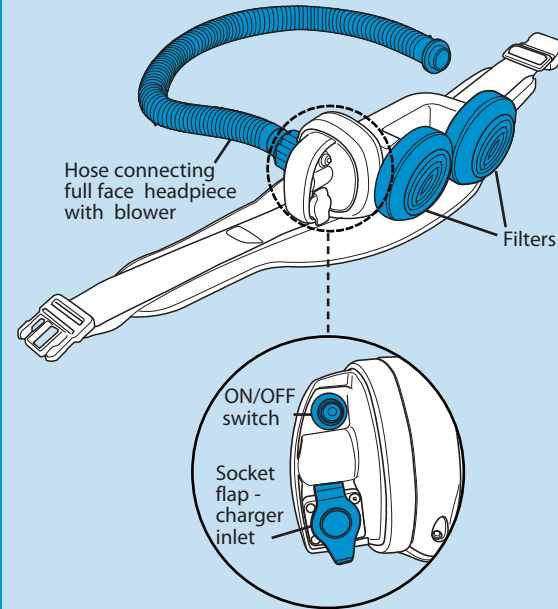

### FULL FACE HEADPIECE

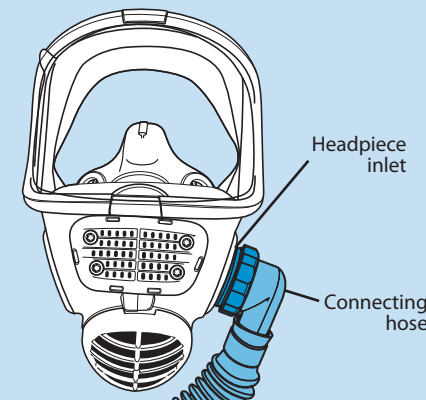

## FILTERS

**FILTERS ARE AVAILABLE FOR PURCHASE FROM HSS HIRE, PLEASE ENSURE YOU ARE AWARE OF YOUR REQUIREMENTS BEFORE CONTACTING HSS HIRE.**

This powered respirator employ standard **Pro2000** filters. Approved filter choice includes **particle filter P, combined filters A-P, B-P, AB-P, ABE-P and ABEK-P.**

The filters may continue to be used until they become clogged to the point where the low flow warning alarm sounds.

The blower power needed depends on the combination of face piece and filters used. When P9 is shown on the digital display, the blower easily achieves full airflow. A lower reading indicates that the blower is using more power to achieve adequate airflow. This is usually the result of filter clogging or hose restriction. (When using particle filters digits P2-P3 indicate to change filter, when using combined filters P6 is adequate as new.)

### FITTING FILTERS

**Choose the right filters for your work. If you are in doubt contact HSS Hire for advice. Fit the filters by screwing in to the filter inlets.**

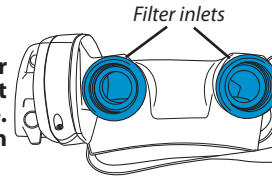

**The filters should never be changed in contaminated areas.**

## GAS AND VAPOUR HAZARD

**ALWAYS CONFIRM THE TYPE AND PRESENCE OF GAS/VAPOUR/HAZARD BEFORE ENTERING THE CONTAMINATED AREA. FOR MORE INFORMATION PLEASE CONTACT HSS HIRE**

**END OF LIFE OF FILTERS, WHEN USED IN THE PRESENCE OF GAS OR VAPOUR, CAN ONLY BE DETECTED BY SMELL OR TASTE IF THE GAS/VAPOUR HAS A GOOD WARNING PROPERTY EG. SOLVENTS.**

## GETTING STARTED

HSS Full Face Power Respirator is designed for supplying filtered air to the facepiece through a breathing hose. This unit contains a motor powered radial fan and automatically calculates the power required to maintain the set flow rate and adjusts the air supply when needed.

**Never use this unit until you have fully read and understood this User Guide and the machine has been properly set up using the information it contains.**

**AN APPROVED RESPIRATOR UNIT ALWAYS CONSISTS OF A BLOWER, FACE PIECE AND FILTERS.**

**ONLY UNITS PROVIDED BY HSS HIRE CAN BE USED.**

**HSS HIRE DOES NOT TAKE RESPONSIBILITY FOR ANY OTHER COMBINATION OF COMPONENTS. USE OF UNAPPROVED COMBINATIONS MAY LEAD TO ILL HEALTH.**

### AUTOMATIC TESTING

An automatic monitoring feature checks that the blower is operating correctly, warns the user of low battery and quickly compensates for changes in airflow. A self-diagnostic test on start-up shows the current status of the respirator on the digital display.