

HSS Hire

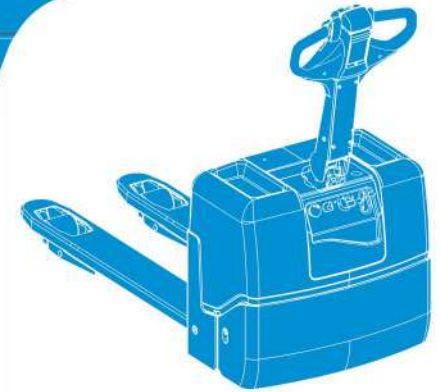

Powered Pallet Truck

Makes light work of moving loaded pallets of up to 1300kg



Code 70233

Control Arm K20

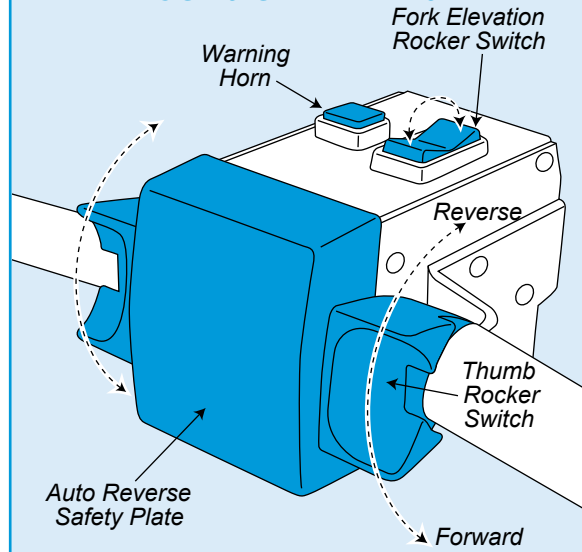

BASIC TECHNIQUES

When loading and unloading, **make sure that the weight is evenly distributed on the pallet** so as not to over balance the load. And **avoid piling the load up too high**, it could topple.

Switch the unit ON and walk to the side of the unit.

When walking with the unit, do not walk backward always face the direction of travel.

Position yourself to the side of the unit so that you remain clear of the units intended path.

Pay special attention to the position of your feet, legs and body to ensure that you don't accidentally entrap or run over yourself.

Lower the control arm and drive the unit to the pallet. Centre the forks under the load and press the fork elevation switch to lift the pallet.

Raise the pallet just enough to clear the floor.

The powered pallet truck can now be driven to its destination. For safety reasons, though, it will not turn through angles greater than 180 degrees.

Always position yourself so you can control the powered pallet truck while staying clear of the raised load.

Do not allow the unit to travel at speed or change its direction of travel abruptly.

Manoeuvre the unit to where the load is required and stop the unit from moving by raising the control arm.

Gently lower the forks until the pallet is fully lowered, then drive the unit clear.

Take your time and don't overdo it. You are more likely to have an accident if you are tired or rushing.

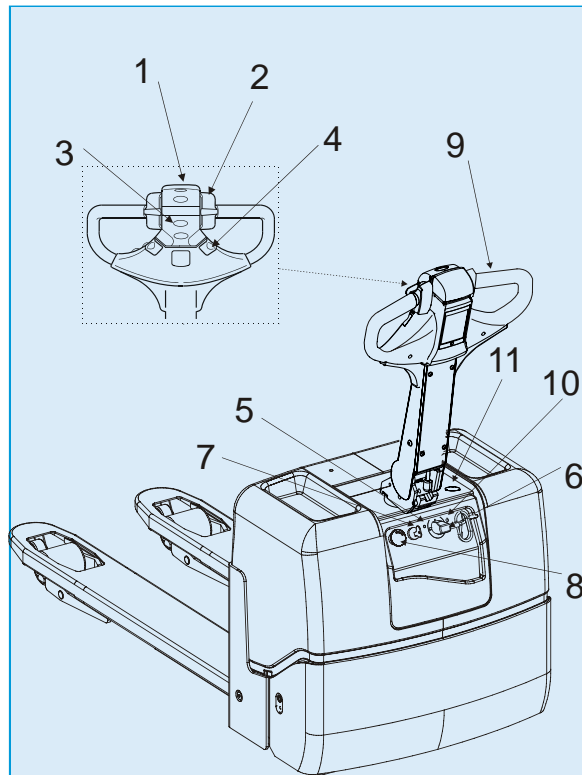

1. Switch for safety reversing
2. Travel direction selector and speed control
3. Control for lifting and lowering the forks
4. Horn
5. LED to indicate start/battery status
6. Charging plug and Start block:
7. Ignition key
8. Emergency switch off
9. Tiller arm and brake
10. LED signalling lorry bed charging has commenced (Option)
11. Battery indicator (Option)

EQUIPMENT CARE

Never push the equipment beyond its design limits. If it will not do what you want with reasonable ease and speed, assume you have the wrong equipment for the job. Contact your local HSS Depot for advice.

Keep the equipment clean, you will find this less of a chore if you clean it regularly, rather than wait until the end of the hire period.

When not in use, **store the equipment somewhere clean, dry and safe** from thieves and unauthorised users.

FINISHING OFF

Gently **lower the load and then remove it from the forks.**

Give the unit a final clean up ready for return, to your local HSS Depot.



...any comments?

If you have any suggestions to enable us to improve the information within this guide please email your comments to safety@hss.com

©HSS Hire Service Group Ltd 2020 No. 104/02

76 Talbot Road, Old Trafford, Manchester, M16 0PQ

www.hss.com

GENERAL SAFETY

For advice on the safety and suitability of this equipment contact your local HSS Depot.



There is a serious risk of personal injury if you do not follow all instructions laid down in this guide.



The hirer has a responsibility to ensure that all necessary risk assessments have been completed prior to the use of this equipment.

This equipment should only be used by a suitably trained operator who has been deemed competent to do so by his/her employer.

This equipment is designed to be used by an able bodied, competent adult who has read and understood these instructions. Anyone with either a temporary or permanent disability should seek expert advice before using it.

Keep children, animals and bystanders away from the work area. Cordon off a NO GO area using cones and either barriers or tape, available for hire from your local HSS Depot.

  **Never use this equipment if you are ill, feeling tired, or under the influence of alcohol or drugs.**

   **Wear practical, protective clothing, gloves, footwear and a protective hard hat. Avoid loose garments and jewellery that could catch in moving parts, tie back long hair.**

 **Use this equipment for vertical lifts only and use on a level area able to take the combined weight of the load and the equipment.**

 **Ensure the load is balanced, stable and that personnel stand clear of the raised load.**

Make sure you know how to operate this equipment safely and are aware of its limitations before you use it.

Make sure that anyone in the immediate work area is warned of what you are doing.

Never exceed the equipment's safe working load of 1,300kg.

Safety Warning

This equipment **MUST NOT** be used to carry or lift personnel.

Do not use this equipment to raise items, which are longer than the fork. Ensure the load has a flat base or if not, is either attached to a suitable pallet or specially designed attachment.

Gradients

This equipment may be driven on a gradient provided the following rules are applied.

- 1. The maximum gradient must not exceed 10%.**
- 2. Never transverse the gradient IE; you may drive the unit up or down a gradient BUT NOT ACROSS it.**
- 3. Never leave the unit unattended when on a gradient.**

When moving loads keep to a sensible pace. If you go too fast, or if you try to wheel a heavy load down a slope, it could run away with you.

Never leave a load unattended.

Check the condition of the equipment before use. If it shows signs of damage or excessive wear, return it to your local HSS Lift & Shift Depot.

ELECTRICAL SAFETY

The HSS powered pallet truck is powered by two 12V batteries. The battery is fitted to the unit and the charger is built in.

The battery charger is designed to plug into a standard 230V 13A earthed power supply

If an extension lead is used for the charger it should be fully unwound and loosely coiled, away from the equipment. Never run leads through water, over sharp edges or where they could trip someone.

Only recharge the batteries in a well-ventilated area. Keep the charging area clear of naked flames, DO NOT SMOKE.

Emergency Procedure

The unit is fitted with a battery disconnect system which will disconnect the battery from the unit in case of an emergency.

If a situation should occur where the unit needs to be isolated from its power supply, take a firm grip of the battery disconnect handle and pull it clear.

Before the battery disconnect system is replaced, ensure the unit is switched OFF.

To recharge the battery make sure the unit is switched OFF then plug the chargers plug into a suitable power supply and switch the supply ON. The charger will recharge the battery in approximately 8 hours.

Once fully charged, switch OFF and unplug the unit from its power supply.

There is a built in safety system which stops the unit working if the plug is not correctly replaced into its storage point. Make sure that you replace the plug securely otherwise the unit will not work.

Charging the unit in very damp or wet conditions can be dangerous.

 **To reduce the risk of electric shock, use a suitable RCD (Residual Current-Operated Device) available from your local HSS Depot. If the charger fails, or if the charger's power supply cable or plug gets damaged, return it. Never try to repair it yourself.**

GETTING STARTED

Place the charging plug into the plug socket on the front panel. Enter the key pad code 70233 to power up the truck.

DO NOT use on soft ground or where there is a risk of subsidence.

Make sure that you are completely familiar with the pallet truck's controls before attempting to use it.

The unit is steered by the main control arm, which also houses the warning horn button, the drive switches, the fork elevation controls and an auto reverse safety plate.

There is a thumb operated rocker switch fitted to both left and right-hand controlled handles. The thumb rocker switch is used to control the direction and speed of travel.

Raise the thumb switch to travel backward and lower to travel forward. The further the switch is moved, the faster the unit will travel.

To raise the forks, press the fork elevation rocker switch back until the pallet is clear of the ground (see illustration).

To lower the forks, press the fork elevation rocker switch forward until the pallet is fully lowered.

Be especially careful when lowering and keep your hands and feet clear of the load.

The main control arm controls the brakes and is also used to steer the unit.

Before the unit can be driven, you must lower the main control arm to release the brakes, but be aware that the brakes can also be activated by fully lowering and holding the arm.

Toyota Model

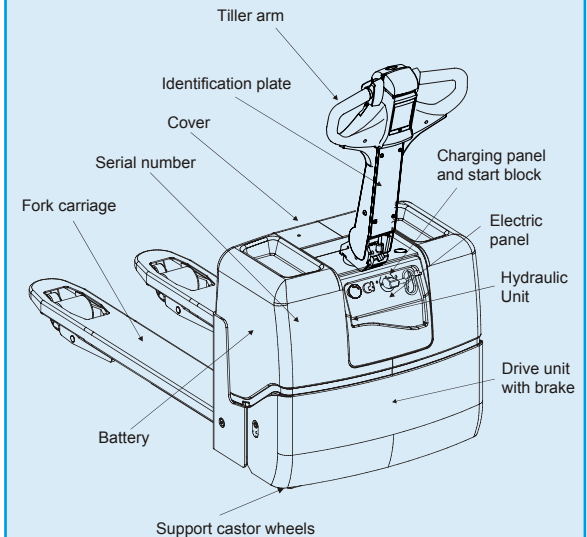

Powered Pallet Truck K20

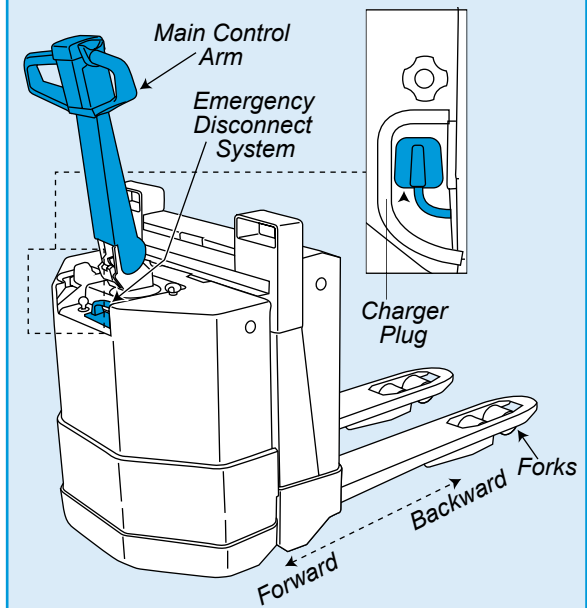

The auto reverse safety plate, fitted to the end of the control arm, immediately sends the unit backward if depressed. This device safeguards against the operator being trapped between an obstacle and the unit. Finally, to switch the unit ON turn the key clockwise, to switch the unit OFF turn the key anti-clockwise.

Know Your Symbols

HSS have created clear Icons to inform the hirer of their responsibilities towards the safe use of hire equipment.

These are designed to reduce the amount of different safety information labels required for each product for hire.

General use PPE / Warning

Clearly marked minimum PPE will be visible on all equipment,



Correct PPE must be worn



HAV Hand Arm Vibration



Danger Rotating blade



Danger Hot exhaust



Danger Electric shock



Caution Abrasive Wheel



Caution Finger trap

Fuel and Supply Types



Pe
Petrol



Di
Diesel



2t
2 - Stroke Petrol



EI
Electric

Safe Procedures

All hirers must understand and respect the safe procedures of all equipment.

It is the responsibility of the hirer to maintain and return the equipment in a clean condition and good working order.



Ro
Read OPS Guide



Ou
Outdoor Use only



HI
Heavy Lifting



Cd
Check Oil daily



Cf
Check Fuel daily



Cw
Check Water daily



Bc
Battery Care

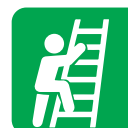

Sh
Safe Height Working



Swl
Refer to Data Plate



V
Check Power Voltage Data Plate

Electrical Safety

Safe wiring procedures.



Ea
Must be Earthed Class 1

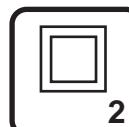

Doi
Double Insulated Class 2



Enl
Earth Live Neutral Wire Coding

Return Responsibility

Charges apply to equipment returned dirty and damaged.



Cc
Cleaning Charge



Rc
Repair Charge